

# NYC STUDIOS / DOUBLE EXPOSURE

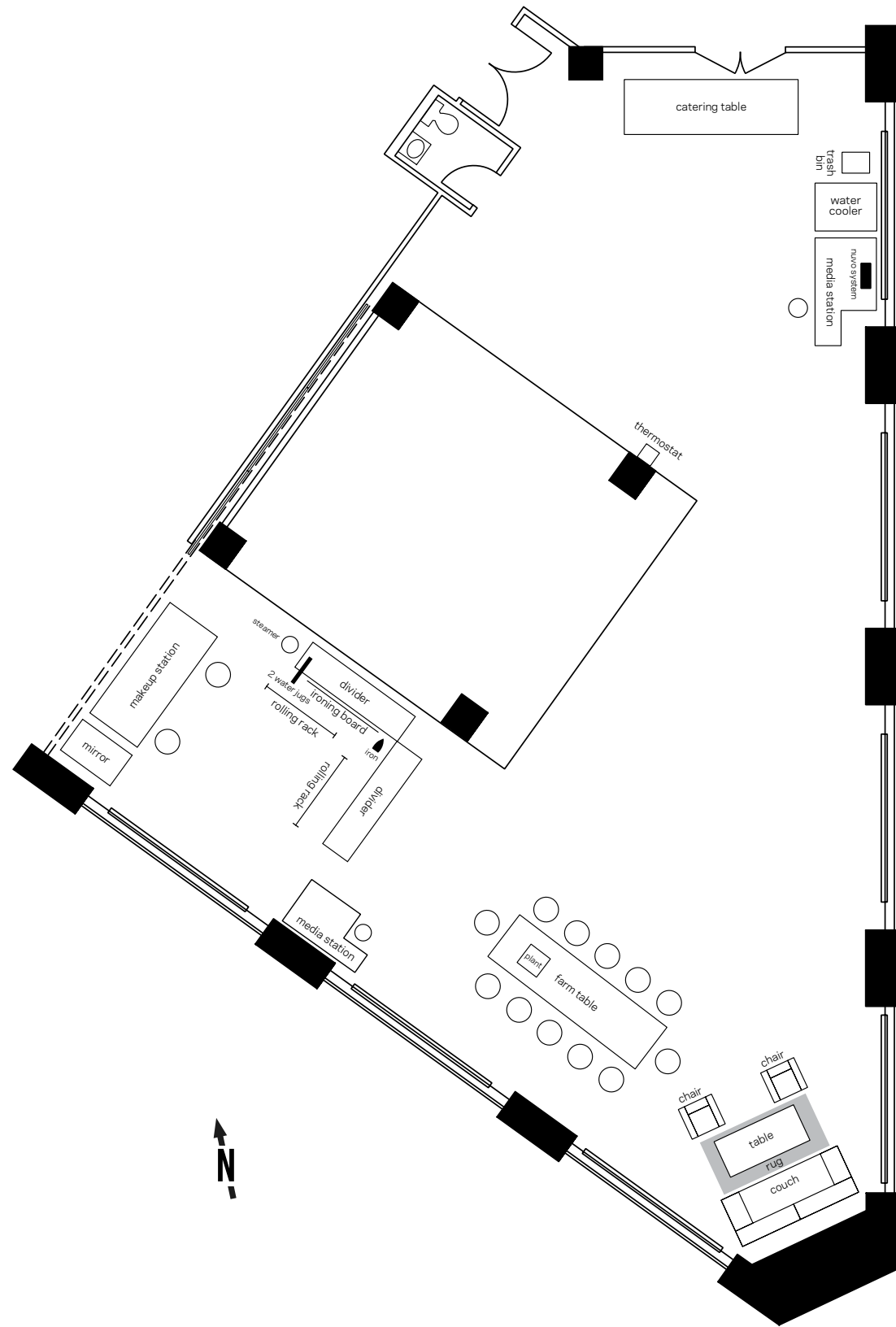

- › 13' ceiling height
- › 3,000 square feet (45' x 63')
- › Power: 200 amps 3 Phase
- › Full Infinity cyc dimensions: 22' wide X 24' long
- › Southern & eastern exposure
- › Double-door access to Cove for a combined 5,300 sq ft
- › Expandable door access to Runway One for a combined 5,500 sq ft & additional expandable access to Runway Two for a total of 8,300 sq ft
- › Private bathrooms & adjustable central air conditioning
- › Media Center: Mac laptop with access to T3 line and telephone
- › Hair & makeup station, dining & catering area, designer lounge area
- › Freight elevator access (7am — 8pm)
- › 24/7 private loading dock on Watts St.









